



2891/DIM/BI maggiolone

design emiliana martinelli, 2016

A diffused-light lamp for LED light source. Aluminum structure painted in white, black, yellow or green colour. White opal methacrylate diffuser. Dimmable electronic driver integrated in the lamp body. Also available in the hanging version, in two sizes.

2891/DIM/BI maggiolone

family:	maggiolone	Body Color:	<input type="radio"/> other available colors <input checked="" type="radio"/> <input type="radio"/>
Designers:	Emiliana Martinelli	Diffuser Color:	<input type="radio"/>
Utilization:	indoor	Body Materials:	aluminium
Typology:	ceiling	Diffuser Materials:	methacrylate
Certifications:			
Market:	This item is available in the following countries: EUROPE		

Dimensions

Width:	-
Height:	14,7 cm
Length:	-
Depth:	-
Diameter:	60 cm

Hole Diameter:	-
Hole Depth:	-
Net weight:	3,8 Kg

Light Source

Watt:	26W
Lumen:	3200 lm
Light Source:	led
CRI:	>80
duration:	50000
CCT:	3000K
Energy degree:	E

Device Specifications

Type of emission:	diffused	Power cable length:	-	Driver:	included
Power:	-	Steel cable length:	-	Power supply assembly:	internal
Light output:	-	Glow Wire Test:	-	Power supply:	electronic dimmable power supply
Beam angle:	-	Impact Resistance:	-	Type of dimming:	-
				Voltage:	230V

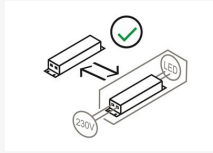
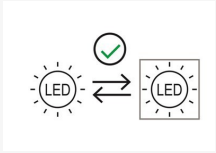

technical drawing

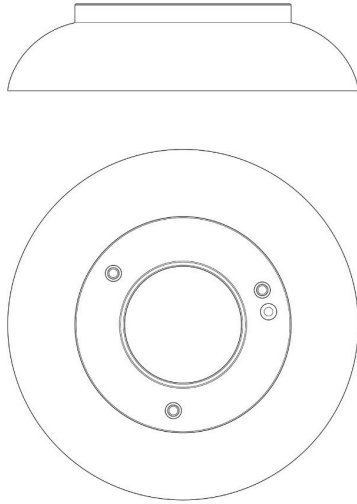

Dimensions

Width: -
 Height: 14,7 cm
 Length: -
 Depth: -
 Diameter: 60 cm

Hole Diameter: -
 Hole Depth: -
 Net weight: 3,8 Kg

photometrics data

